

KAUMUALII STREET

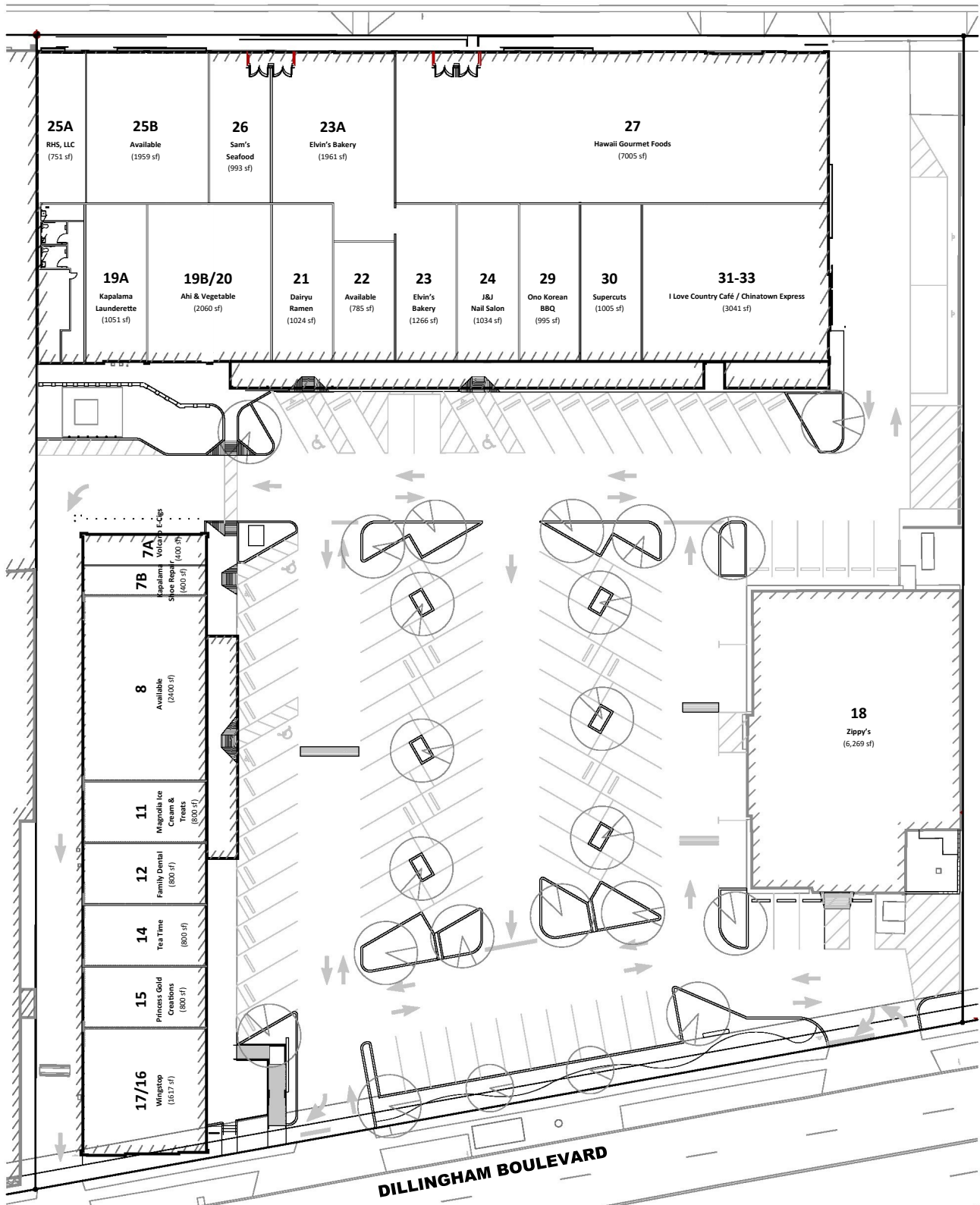

DILLINGHAM BOULEVARD

1. This exhibit is diagrammatic. It is intended only for the purpose of indicating the location of the demised premise within the project. It does not purport to show the exact or final location of columns, walls, stairways or other Architectural, Structural, Mechanical, or Electrical elements. The landlord reserves the right to eliminate, to add and to make changes to the sizes and/or locations of such elements as may be required from time to time.

2. The tenant, the Tenant's Architect & the Tenant's contractor have complete and total responsibility to verify all conditions and dimensions, and all utility connection points, in the field before starting any design, documentation & construction work.

KAPALAMA CENTER

1210 DILLINGHAM BLVD
HONOLULU, HI 96817
TMK: (1) 1-5-022-002

